

# PRO-6

## HEAVY-DUTY SINGLE AXIS JOYSTICK CONTROLLER

### Construction:

The ultra-rugged PRO-6 provides precise proportional control for electro-hydraulic valves and AC/DC variable speed drives. Your specific control requirements can be accommodated by a variety of standard and custom engineered electronic amplifiers.

### Application:

For use on Cranes, Agricultural, Mining, Paving and Forestry equipment.

### Features:

- Heavy duty construction
- 2.6" mounting centered between stacked controllers.
- Multiple mounting arrangements available
- Long life, compression type return spring system.
- Friction held handle
- Large variety of optional handle configurations including; triggers, rocker switches, mechanical interlock, push-buttons and thumb wheels.
- Proportional Feathering Control PFC, PFC/CR or MPFC Electro-hydraulic valve drive boards.
- 20 Million cycle mechanical operating life.
- Rugged 10mm diameter handle shaft.
- Toolled fixed cams.



## PRO-6 ORDERING INFORMATION

- Basic Assembly:** 4.3" shaft length, 1 ¼" dia., round ball handle and boot supplied standard.
- Handle:** Reference handle section for additional handle options and custom grips.
- Contacts:** (4) Micro switches max. Optional gold contacts available upon request.
- Potentiometers:** 0.5 watt 5 million cycles provided standard. Specify resistance and type required. Standard or center tapped. (Consult factory for custom requirements).
- Electronics:** See PFC, PFC/CR or MPFC Proportional Feathering Control electronics for ordering information.

---

### PRO-6 Technical Data

---

#### Mechanical:

- **Operating Temperature:** -25<sup>o</sup>-+70<sup>o</sup>C
- **Detented Positions:** 0° detent
- **Gear Ratio:** 3.5:1
- **Mechanical Life:** 20 million cycles
- **Handle Travel:** ±36°for proportional
- **Potentiometer Rotation:** ±126°

#### Electrical:

- **Contacts:**  
(4) Micro switches max
- **Ratings:** 10 Amps 125, 250 VAC
- **Potentiometers:** 0.5 watt, 5K, 3 wire or 10K 4 wire center tap. 5 million revolutions. (Consult factory for special potentiometer requirements.)
- **Electronics:** PFC, PFC/CR & MPFC; Electro-Hydraulic Proportional Valve Amplifiers

# PRO-6 DIMENSIONS

## RH ROCKER HANDLE

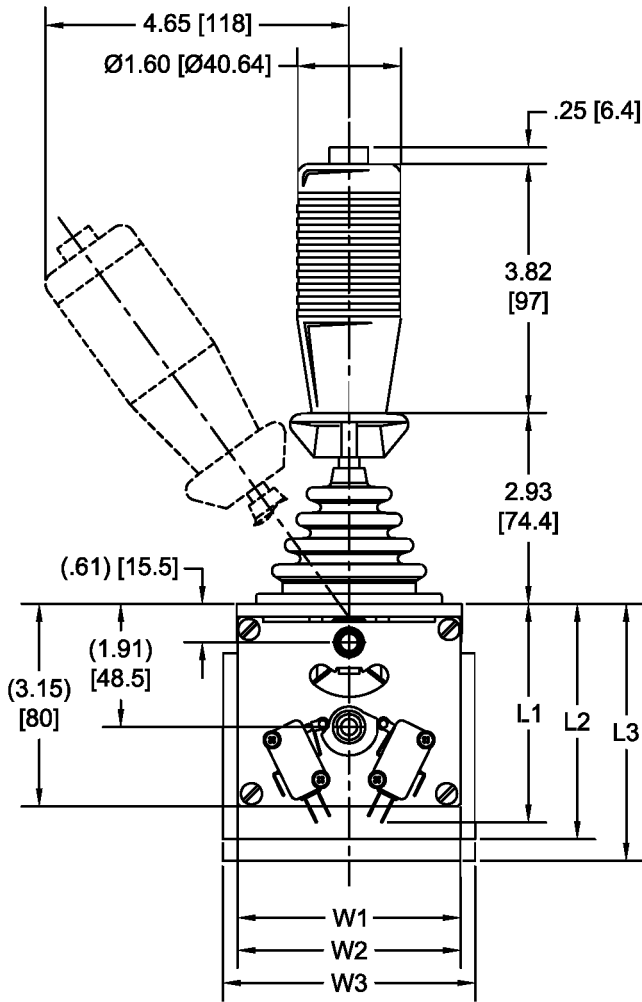

## ROUND BALL HANDLE

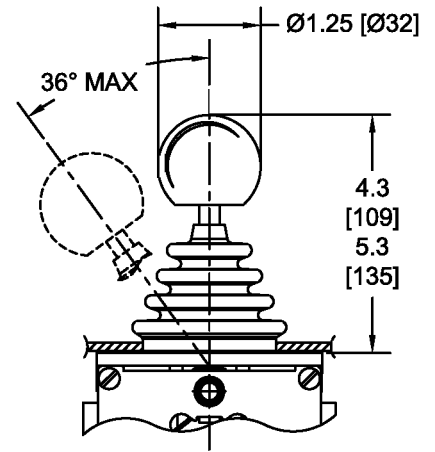

## 2 PC. HANDLE

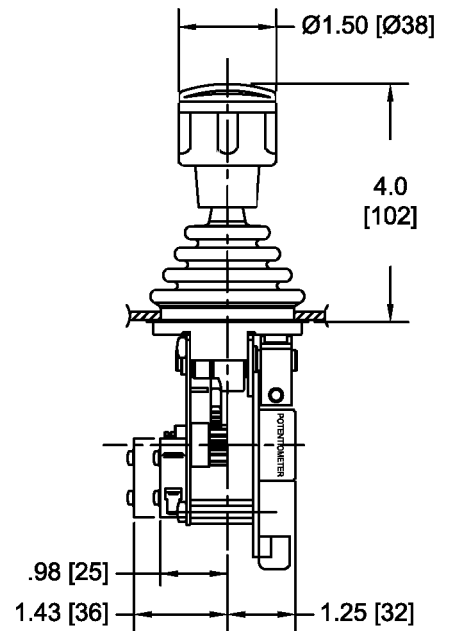

PCB DIMENSIONS				
LENGTH		WIDTH		CONFIGURATION
L1	3.4 [86]	W1	3.5 [88]	POTENTIOMETER, ESS420, OR ESS10010
L2	3.7 [95]	W2	3.5 [88]	PFC (PROPORTIONAL FEATHERING CONTROL)
L3	3.9 [100]	W3	4.0 [102]	PFC-CR OR MPFC-CR

## MOUNTING DIMENSIONS

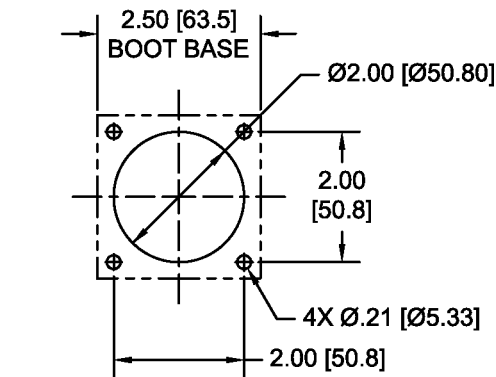

STYLE "A" PANEL MOUNTING

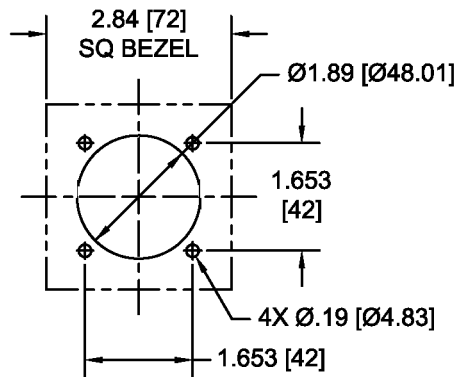

STYLE "B" PANEL MOUNTING  
(OPTIONAL)

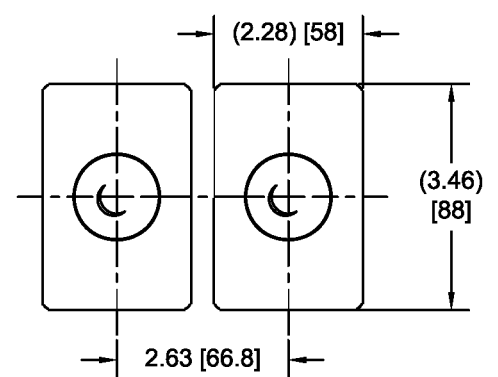

STYLE "A" MOUNTING MULTIPLES

**J.R. MERRITT**  
**CONTROLS, INC.**

Stratford, CT • 1-800-333-5762 • [www.jrmerritt.com](http://www.jrmerritt.com)

# PRO-6 DIMENSIONS

**FG3 HANDLE**

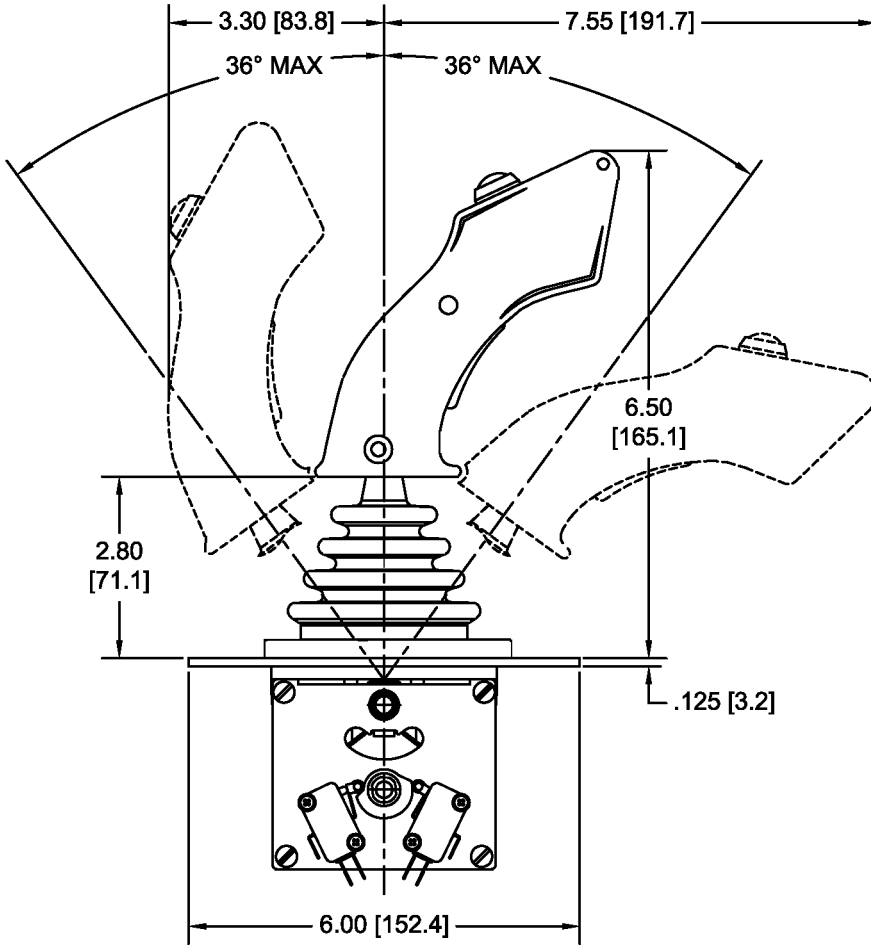

**BH HANDLE**

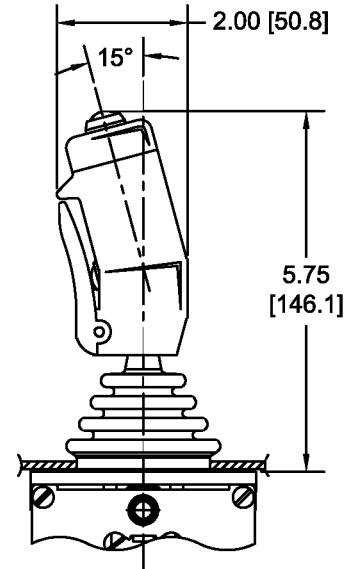

**MG 27 HANDLE**

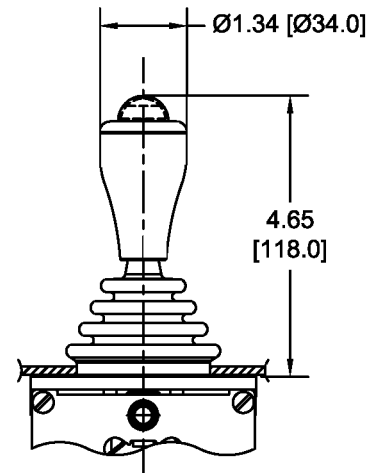

**MOUNTING DIMENSIONS**

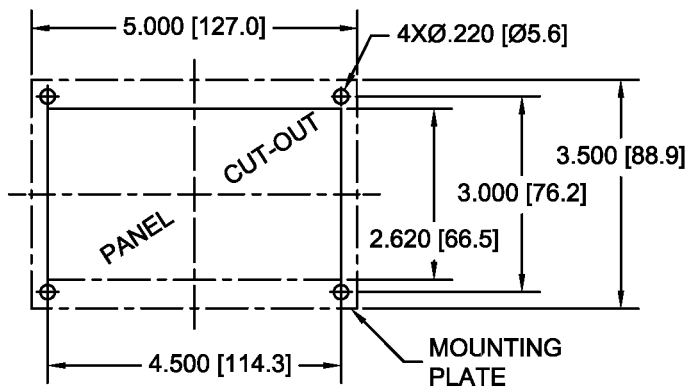

**PRO-6 "DROP-IN" MOUNTING**

**MECH. INTERLOCK HANDLE**

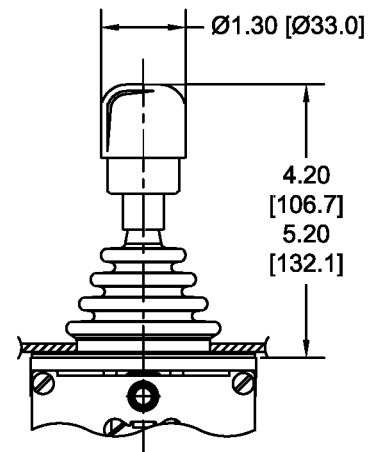

**J.R. MERRITT**   
**CONTROLS, INC.**

Stratford, CT • 1-800-333-5762 • [www.jrmerritt.com](http://www.jrmerritt.com)